

REAR SHOCK ABSORBER REMOVAL/INSTALLATION

B3E021428700W01

1. Remove in the order indicated in the table.

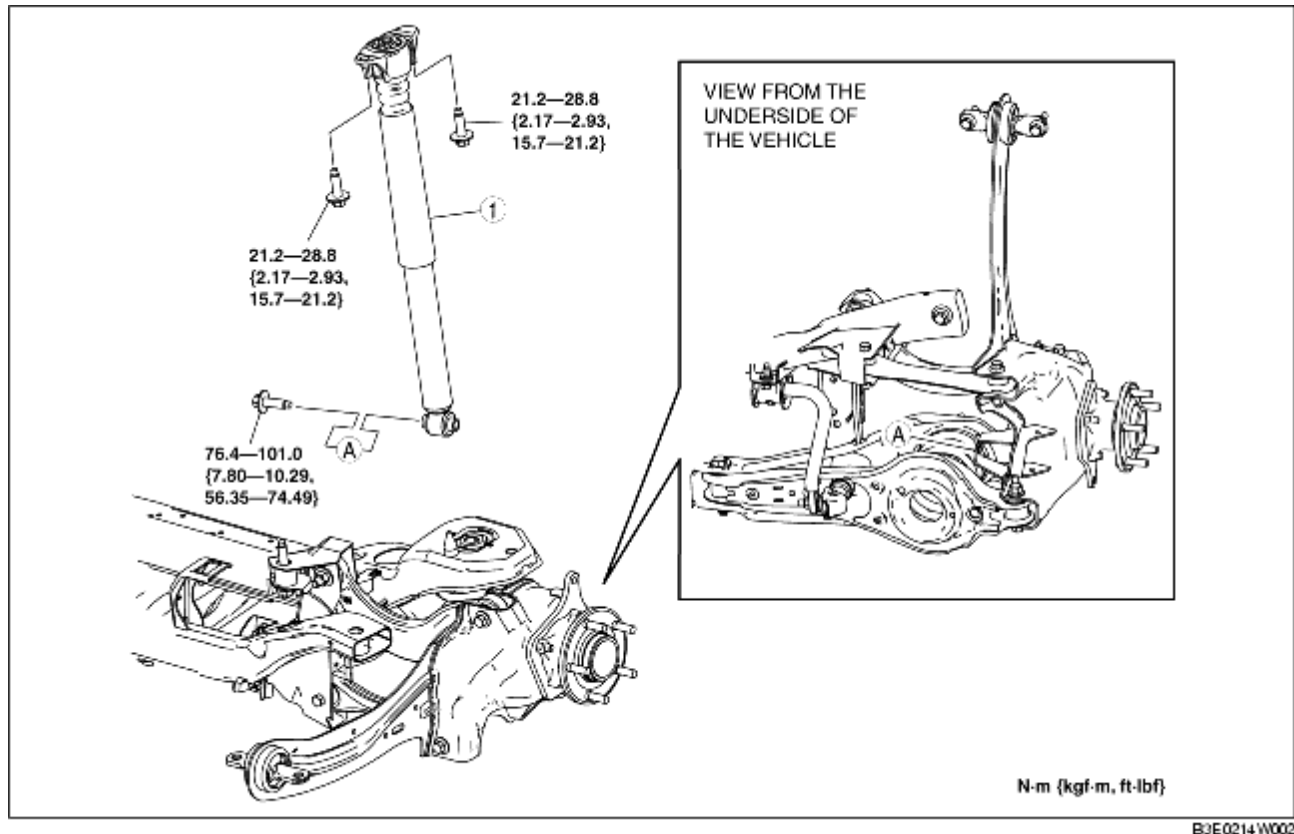

B3E0214W002

- | | |
|---|---|
| 1 | Rear shock absorber
(See Rear Shock Absorber Removal Note.) |
|---|---|

2. Install in the reverse order of removal.

Rear Shock Absorber Removal Note

1. Support the rear axle using a jack.

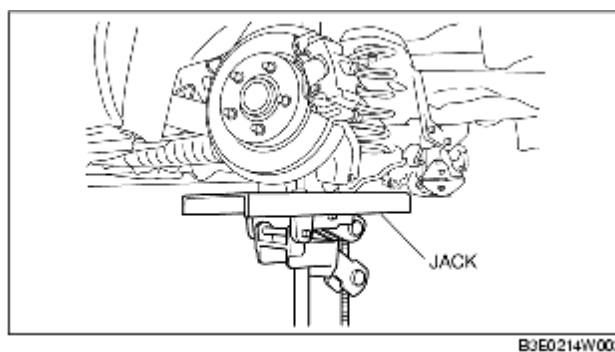

B3E0214W003

2. Remove the rear shock absorber.